

STEEL EYEBOLT WITHOUT SHOULDER
1/2"-13 THREAD SIZE 2-1/2"lg
(OPTION)

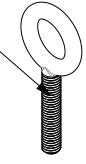

DROP-IN ANCHOR HDI-L +
1/2"-13

MOLD ASSEMBLY

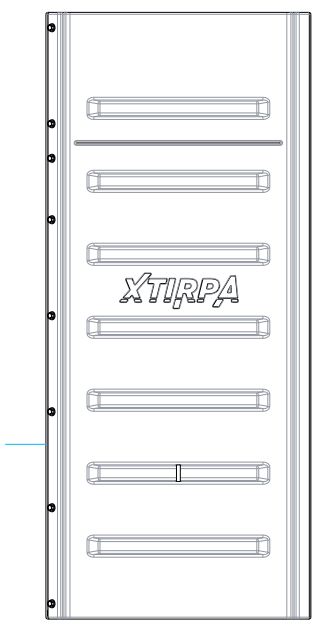
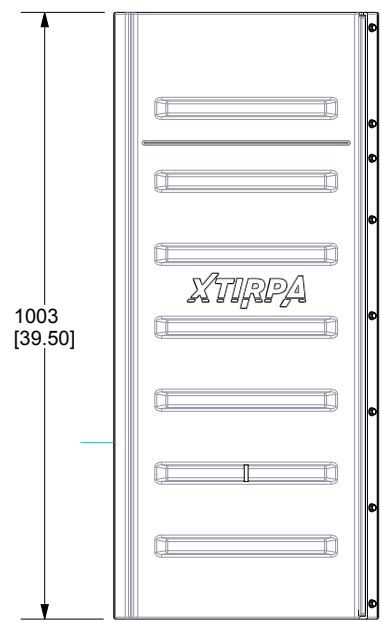
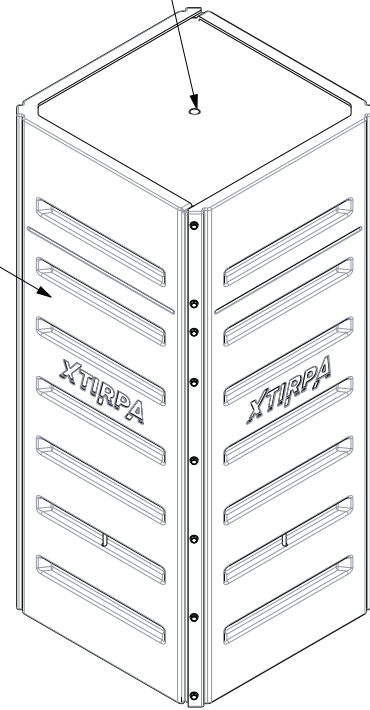

NOTE:
 -CONCRETE REQUIRED: 0,18m³ (6.46 ft³)
 -NORMAL WEIGHT CONCRETE WITH A DENSITY OF 2200 TO 2600 kg/m³
 -DURING COLD WEATHER, TAKE ALL NECESSARY PRECAUTION TO PREVENT FRESH CONCRETE FROM FREEZING,
 ESPECIALLY WITHIN THE FIRST 24 HOURS AFTER PLACEMENT.

INNOVA PUBLIC UTILITY PRODUCTS INC.				
TITLE:				
MOLD / CONCRETE WITH ANCORAGE FOR XLT				
WEIGHT :		DRAWN BY:		
(kg)	(lb)	P.PETIT		
401.5	885.1	DATE: 18/03/2021		
		SCALE:		
		2:25		
MATERIAL:		SHEET(S):	FORMAT:	No. DRAWING:
		1 / 1	A	DA5039-59_ANG_06
<small>© 9105-0732 QUEBEC INC., under exclusive license to PRODUCTS DE SERVICES PUBLICS INNOVA INC., (hereinafter "INNOVA"). All rights reserved. Protected by the Copyright Act in Canada and international treaties and conventions relating to copyright. Violators are subject to criminal prosecution and other legal remedies for infringement. Any reproduction, adaptation or other use or disclosure of any kind, in whole or in part, and in any form or by any means whatsoever either, is strictly prohibited and requires the prior written consent of INNOVA. The data is the exclusive property of 9105-0732 QUEBEC INC., under exclusive license to INNOVA and cannot be used or disclosed in any way without the prior written consent of INNOVA.</small>				